

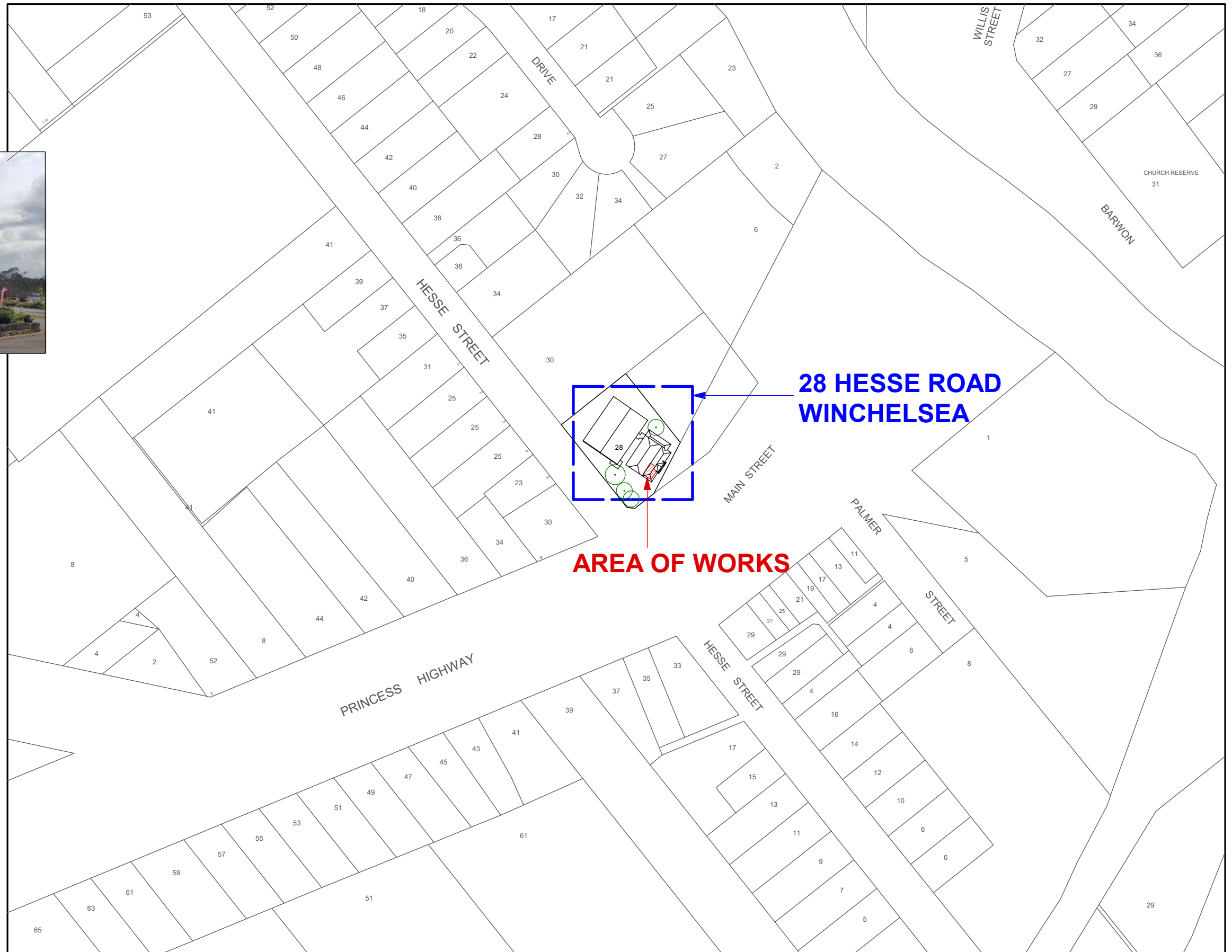

WINCHELSEA TEA ROOMS
FRONT ELEVATION



LOCALITY PLAN
SCALE 1:2000

LOCALITY PLAN

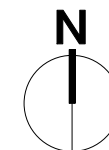

Odoriso & Stolfo Architects P50132 ABN 91 089 757 581 526 Camberwell Rd Camberwell 3124 copyright Ph. 9889 1874 Fax. 9889 7492 Email: bloc@optusnet.com.au	28 HESSE ROAD WINCHELSEA 3230	Date: JAN 2019 Scale: 1:2000 @ A3 Drawn: N. Weaver Sup: G. Stolfo
	PROPOSED CHANGING PLACES	Drawing No: 18-40-TP01
	Client: Surfcoast Shire Council	
	TOWN PLANNING ISSUE DATE 31.01.2019	

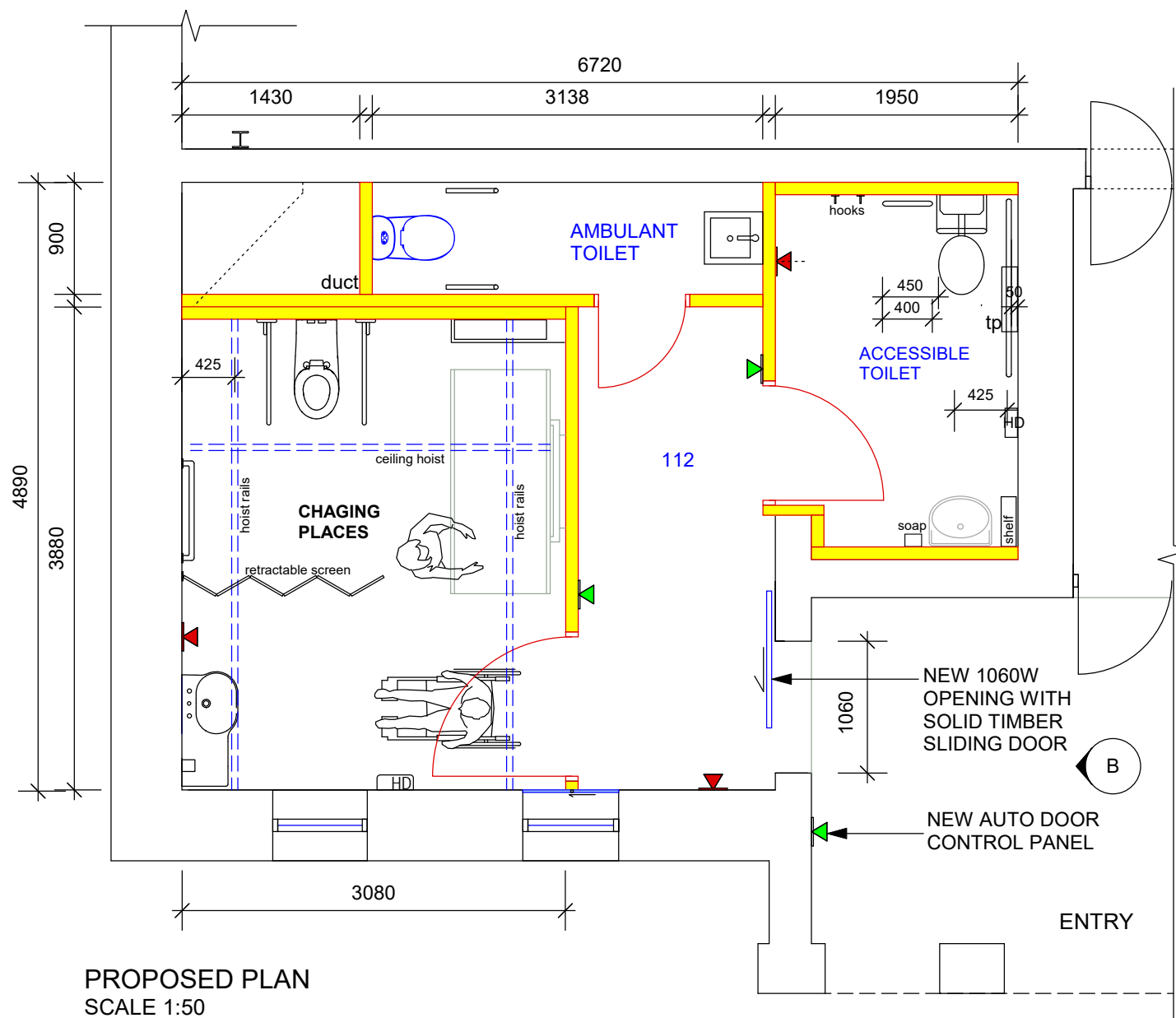

PROPOSED PLAN
SCALE 1:50

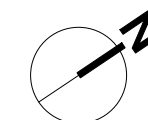
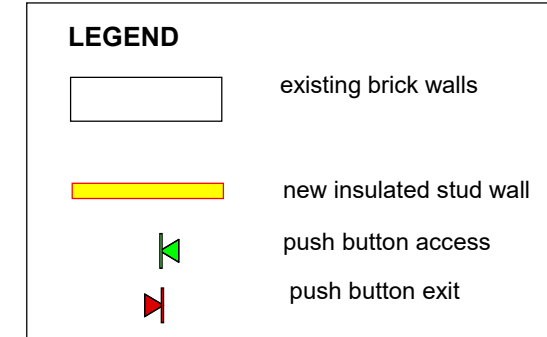
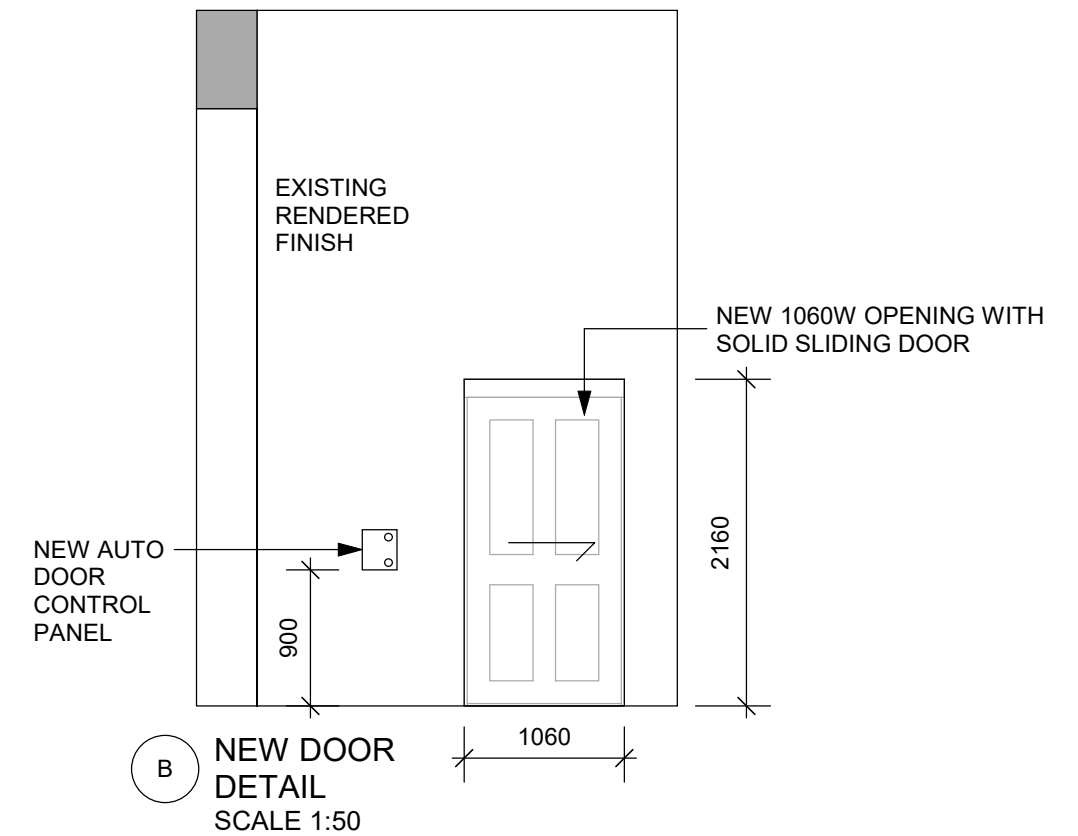

Odoriso & Stolfo Architects
P50132 ABN 91 089 757 581
526 Camberwell Rd
Camberwell 3124 copyright
Ph. 9889 1874 Fax. 9889 7492
Email: bloc@optusnet.com.au

28 Hesse St,
Winchelsea VIC 3241
Client: Surfcoast Shire Council

Date: JAN 2019
Scale: 1:50 @ A3
Drawn: N. Weaver
Sup: G. Stolfo

**Drawing No:
18-40-TP04**

PROPOSED PLAN