

Location Plan NTS

Legend

- Existing Predominantly Introduced vegetation (refer Flora & Fauna Assessment)
- Existing 'Grassy Woodland' roadside vegetation (refer Flora & Fauna Assessment)
- Existing 'Heathy woodland' roadside vegetation (refer Flora & Fauna Assessment)
- Existing scattered trees retained (refer Flora & Fauna Assessment)
- Existing scattered trees removed (refer Flora & Fauna Assessment)
- Existing vegetation removed (refer Flora & Fauna Assessment)
- Proposed street trees within grassed nature strips (refer Street Tree Plant Schedule)
- 2.5m wide gravel shared footpath
- Low Density Residential Access Place 20m road reserve
- Residential Lots
- Reserves subject to detailed design via permit process.
- Northern boundary landscape strip (8m wide, fenced with rural post and wire fence)
- Eastern boundary landscape strip (inside lot, 8m wide)
- Southern boundary landscape strip (5m wide)
- Footpath - location indicative only (to be confirmed during detailed design stage)

Southern Boundary Landscape Strip (5m wide) Plant Schedule
Landscape strip adjacent to tall roadside vegetation

BOTANICAL NAME	COMMON NAME	MATURE SIZE (h x w, m)
Shrubs		
Acacia paradoxa	Hedge Wattle	4 x 3
Acacia verniciflua	Varnish Wattle	4 x 3
Leptospermum continentale	Prickly Tea Tree	3 x 3
Hymenanthera dentata	Tree Violet	4 x 3

2 rows, planted at 2m centres

Southern Boundary Landscape Strip (5m wide) Plant Schedule
Landscape strip adjacent to low / sparse roadside vegetation

BOTANICAL NAME	COMMON NAME	MATURE SIZE (h x w, m)
Trees		
Allocasuarina verticillata	Drooping Sheoke	9 x 6
Eucalyptus baxteri	Brown Stringy Bark	9 x 6
Eucalyptus ovata	Swamp Gum	7 x 5
Eucalyptus radiata	Narrow-leaf Peppermint	7 x 4

Single row, planted at 8 - 12m centres

Groundcovers		
Lomandra longifolia	Spiny-headed Mat-rush	1 x 0.7
Dianella admixta	Black Anther Flax Lily	0.7 x 0.5
Gahnia radula	Thatch Saw-sedge	1 x 0.7
Goodenia lanata	Trailing Goodenia	0.2 x 1

Planted at 3 - 5 no. per m²

Northern and Eastern Boundaries Landscape Strip (8m wide)
Plant Schedule

BOTANICAL NAME	COMMON NAME	MATURE SIZE (h x w, m)
Trees		
Allocasuarina verticillata	Drooping Sheoke	9 x 6
Eucalyptus baxteri	Brown Stringy Bark	9 x 6
Eucalyptus ovata	Swamp Gum	7 x 5
Eucalyptus radiata	Narrow-leaf Peppermint	7 x 4

Planted at 8 - 12m centres

Shrubs		
Acacia paradoxa	Hedge Wattle	4 x 3
Acacia verniciflua	Varnish Wattle	4 x 3
Leptospermum continentale	Prickly Tea Tree	3 x 3
Hymenanthera dentata	Tree Violet	4 x 3

3 - 4 rows, planted at 2m centres

This plan/proposal complies with the requirements of Clause 43.04 of the Surf Coast Planning Scheme.

Approval No: 14/0413

Plan of Date: 27/11/15

Signature for the Responsible Authority

THIS IS NOT A BUILDING APPROVAL

POSSIBLE FUTURE SUB STATION

ROAD

PEDESTRIAN LINK

PEDESTRIAN LINK

RESERVE

RESERVE

GROSSMANS ROAD

Street Trees Species



Acacia melanoxylon (Blackwood)

Allocasuarina verticillata (Drooping Sheoak)



Banksia marginata (Silver Banksia)

Eucalyptus radiata (Narrow Leaf Peppermint)

Street Tree Plant Schedule

KEY	BOTANICAL NAME	COMMON NAME	MATURE SIZE (h x w, m)
Trees			
	Allocasuarina verticillata	Drooping Sheoke	9 x 6
	Acacia melanoxylon	Blackwood	7 x 4
	Banksia marginata	Silver Banksia	5 x 3
	Eucalyptus radiata	Narrow-leaf Peppermint	7 x 4

No.	Issue	Date
01	Issued for Planning Permit	14.10.2015

460 Grossmans Road
Bellbrae

Landscape Master Plan

MEXTED RIMMER ASSOCIATES
MEXTED RIMMER ASSOCIATES PTY LTD
14 MC LARTY PLACE GELONGVILLE VIC 3209
TEL: 03 5229 1414 FAX: 03 5229 3209
EMAIL: mail@mextedrimmer.com

project no:	2758
drawing no:	LMP1.01
sheet no:	1 of 2
designed by:	GM
drawn by:	EW
date:	14.10.2014
scale:	1:1500 @ A1 1:3000 @ A3

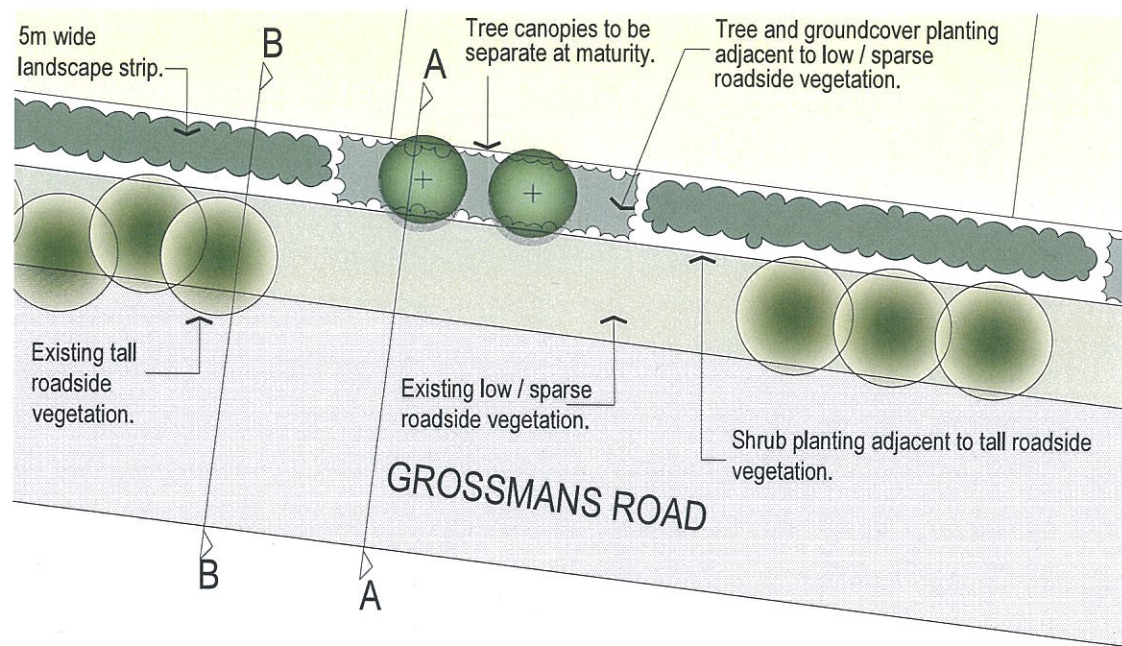

1 LMP1 Typical 5m Wide Landscape Strip to Southern Boundary NTS @ A1

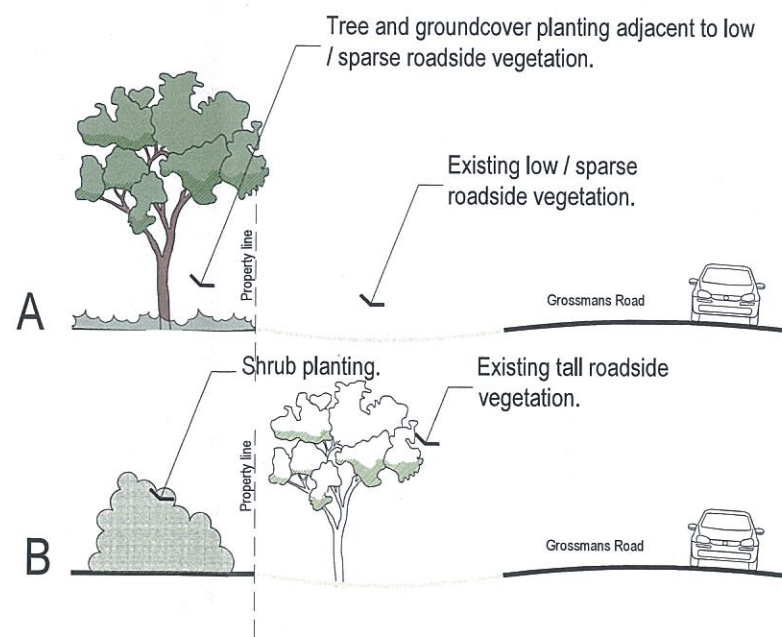

2 LMP1 Typical 5m Wide Landscape Strip to Southern Boundary - Sections A & B NTS @ A1

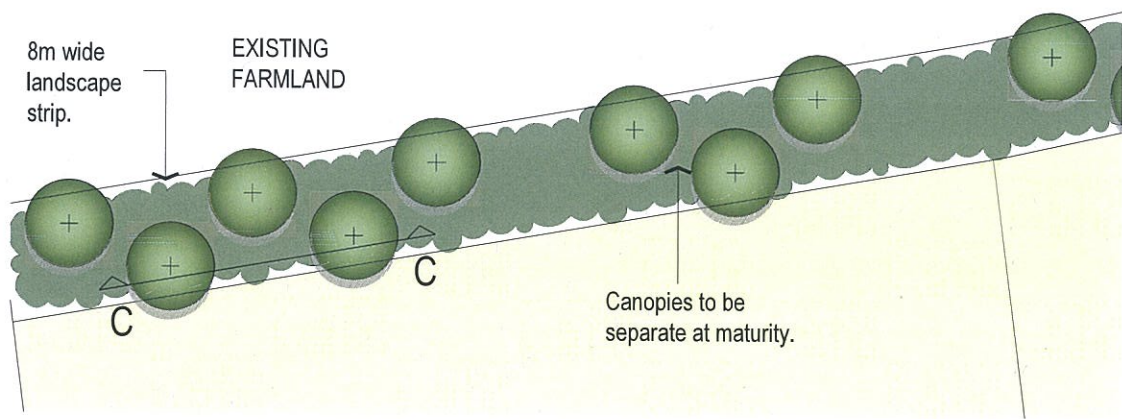

3 LMP1 Typical 8m Wide Landscape Strip to Northern Boundary Plan NTS @ A1

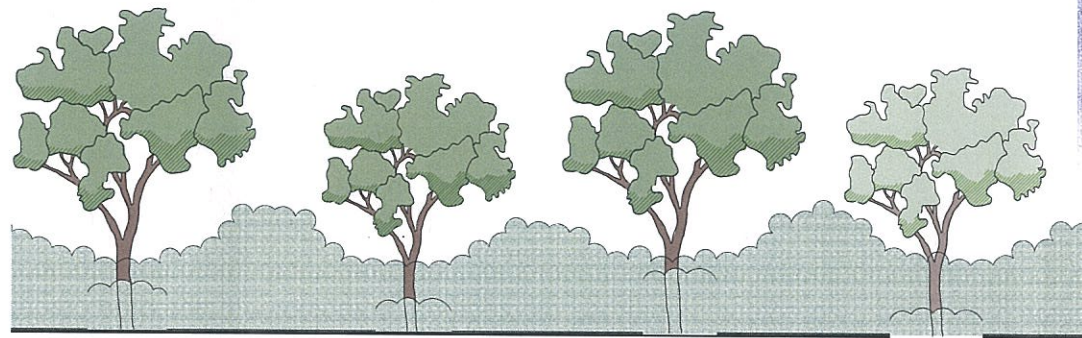

4 LMP1 Typical 8m Wide Landscape Strip to Northern Boundary - Section C NTS @ A1

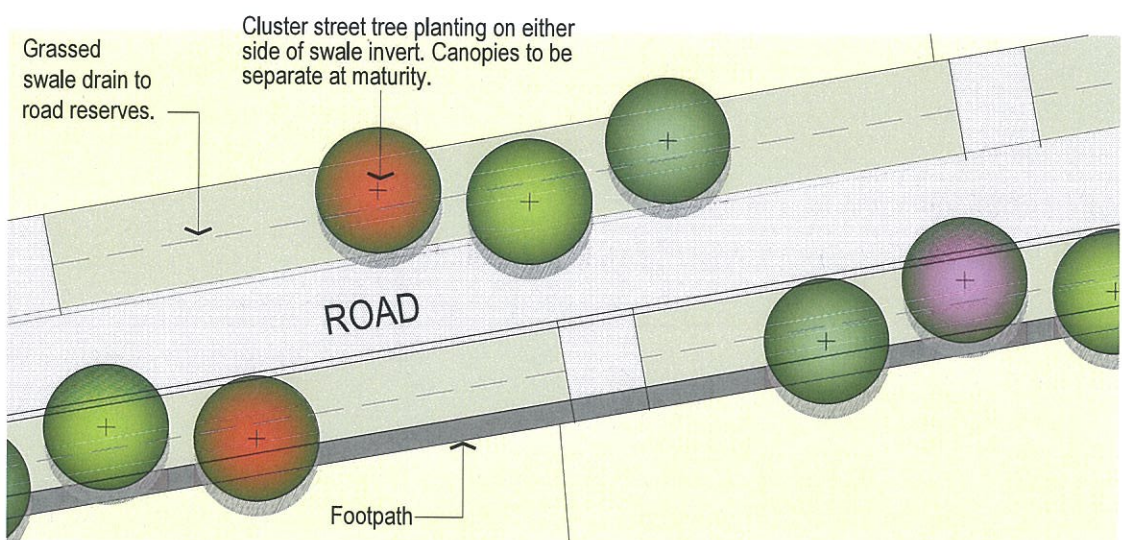

5 LMP1 Typical Cluster Street Tree Planting Arrangement Plan NTS @ A1

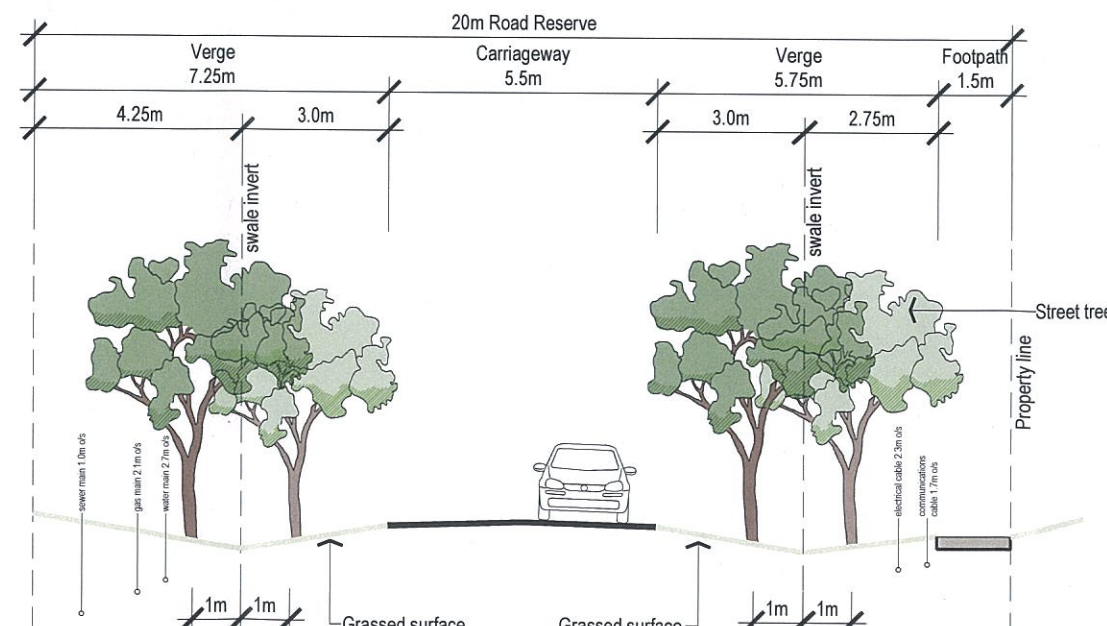

6 LMP1 Low Density Residential Access Place Typical Cross Section NTS @ A1

Legend

- Proposed trees to landscape strips
- Proposed screen planting
- Existing tall roadside vegetation
- Proposed street trees within grassed nature strips (refer Street Tree Plant Schedule)
- Low Density Residential Access Place 20m road reserve
- Residential Lots
- Footpath - location indicative only (to be confirmed during detailed design stage)

PLANNING & DESIGN SERVICES
SURF COAST SHIRE COUNCIL
 This plan/proposal complies with the requirements of Clause 43.04 of the Surf Coast Planning Scheme.
 Approval No: 14/0413
 Plan of Date: 27/11/15
 Signature for the Responsible Authority
 THIS IS NOT A BUILDING APPROVAL



Typical Cluster Street Tree Planting Arrangement Image

No.	Issue	Date
01	Issued for Planning Permit	14.10.2015

460 Grossmans Road
 Bellbrae

Landscape Master Plan



project no: 2758
 drawing no: LMP2.01
 sheet no: 2 of 2
 designed by: GM
 drawn by: EW
 date: 14.10.2014
 scale: 1:250 @ A1
 1:500 @ A3